



# Portable Stand

**360°**

Panoramic Rotation  
For easy panoramic shooting

**45°**

Pitch Angle  
For multi-view adjustment

**5kg**

Max Load Capacity  
(With Support Stand)

**795mm**

Max Length

## Compatibility:

HORIZON Pro, HORIZON, Elfin, Halo, Halo+, MoGo, MoGo Pro, MoGo Pro+





# Dual Combo Stand

Extra stability. Extra peace of mind

- Innovative, durable, & patented design
- Dual triangulated legs ensure balanced & stable weight distribution
- Double stand stability for various load-bearing needs



Standard Stand



Support Stand<sup>1</sup>

# Versatile Dual Mode

Set up in one, easy step

- Works as a desktop or floor stand
- Opens and expands fully with one pull



▲ Floor Stand Mode

◀ Desktop Stand Mode





## Lightweight & Easy to Carry

- Long-lasting strength in a sleek design
- 34cm folded length, making storage & transport more convenient

**565g**

Net Weight  
(Standard)

**758g**

Net Weight  
(With Support Stand)

**3kg<sup>2</sup>**

Max Load Capacity  
(Standard)

**5kg**

Max Load Capacity  
(With Support Stand)

## 1/4- inch screw supports compatibility with multiple devices<sup>3</sup>





# More Details



## Flocked Travel Bag

- Convenient storage
- Portable for easy transport



## Engineered Thumb Screw

- Anti-spin-out design
- Prevents accidental falls



## Non-Slip Silicone Padding

- Protects floors from scratches
- Stable, anti-slip positioning

## To ensure a better user experience, please read the following notes carefully:

- Follow the < installation steps > to use the product correctly.
- Please adhere to the max load capacity when mounting projectors and other devices.
- Non-professionals should avoid disassembling the bracket or stand by themselves.
- Ensure that the setup surface is even and flat. If placed in potholes or tilted in other uneven positions, the machine may tip over completely. Please operate with caution.
- Avoid using the product aggressively, as it may lead to deformation or severe damage.

## Installation Steps

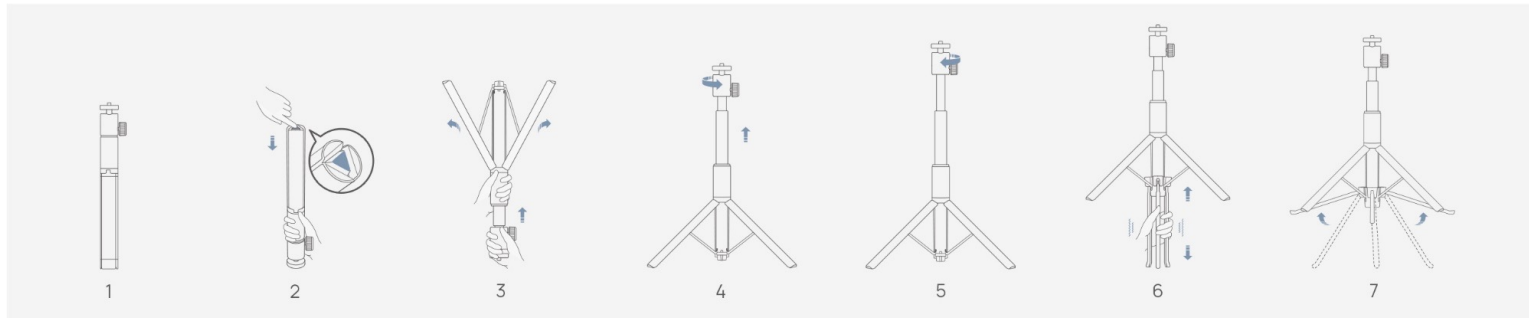

1. The support stand acts extra support for more stable operation.
2. 3kg is the max load capacity of the stand without the support stand.
3. Please ensure only appropriate conversion accessories are used when mounting cameras, smartphones, and other devices.  
For XGIMI projectors, if there is no screw hole at the bottom of the machine, please use an appropriate conversion plate;  
For other products, check the screw hole standard at the bottom and prepare an adapter as required.